

Because life is

Petty Real™

For Sale



16 Stockbridge Road
Padiham BB12 7HA

£50,000



Popular residential area within five minutes to the local town centre amenities of Padiham, Tesco Superstore and Leisure Centre.

Key Features:

- Mid terrace house
- Close to town centre amenities
- Large dining kitchen
- 4-Pce family bathroom
- Cosmetic upgrade
- Popular residential area
- Lounge with gas fire
- 2 Double bedrooms
- GFCH & dg
- New carpets & lino

Tenure: Leasehold
EPC Rating: D
Council Tax Band: A



2 BEDROOM House - Terraced

GROUND FLOOR
33.0 sq.m. (355 sq.ft.) approx.

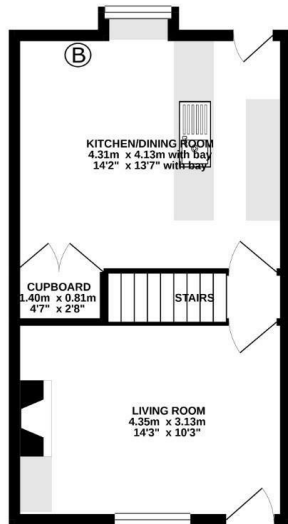

1ST FLOOR
32.1 sq.m. (345 sq.ft.) approx.



TOTAL FLOOR AREA: 65.1 sq.m. (700 sq.ft.) approx.

Whilst every attempt has been made to ensure the accuracy of the floorplan contained here, measurements of doors, windows, rooms and any other items are approximate and no responsibility is taken for any error, omission or mis-statement. This plan is for illustrative purposes only and should be used as such for any prospective purchaser. The services, systems and appliances shown have not been tested and no guarantee is given to their condition or efficiency can be given.
Made with Metropix ©2020

Main Description:

Popular residential area within five minutes to the local town centre amenities of Padiham, Tesco Superstore and Leisure Centre.

The property comprises on the ground floor lounge with gas fire, large dining kitchen with gas cooker, white kitchen units with chrome fixtures and fittings and separate storage area.

Ascending to the first floor there are two double bedrooms, both with fitted wardrobes, well presented four piece family bathroom suite in white with separate shower.

The property is further complemented by the modern day comforts of gas central heating via a combination boiler and double glazing.

Externally to the rear is a yard.



IMPORTANT: We would like to inform prospective purchasers that these sales particulars have been prepared as a general guide only. A detailed survey has not been carried out, nor the services, appliances and fittings tested. Room sizes should not be relied upon for furnishing purposes and are approximate. If floor plans are included, they are for guidance only and illustration purposes only and may not be to scale. If there are any important matters likely to affect your decision to buy, please contact us before viewing the property