

Because life is

Petty RealTM

For Sale



22 Sutherland Street
Colne BB8 0DB

£69,950



Key Features:

- 2 bedroom inner terrace
- blank canvass
- 2 reception rooms
- central heating

Tenure:
EPC Rating: E
Council Tax Band:



11 Albert Road, Colne, Lancashire, BB8 0RY
T: 01282 868686

www.pettyreal.co.uk

2 BEDROOM House - Terraced

GROUND FLOOR
39.3 sq.m. (423 sq.ft.) approx.

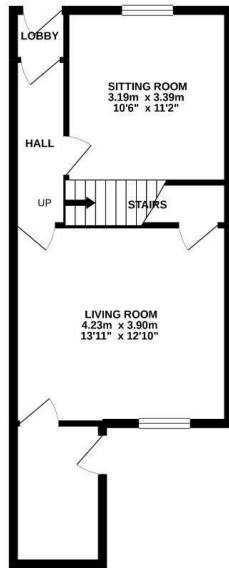

1ST FLOOR
34.4 sq.m. (371 sq.ft.) approx.

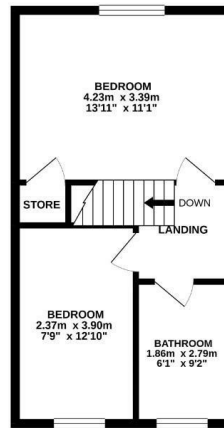

TOTAL FLOOR AREA: 73.7 sq.m. (794 sq.ft.) approx.
Whilst every attempt has been made to ensure the accuracy of the floorplan contained herein, measurements of floor, ceiling, rooms and site area have not been taken with a view to providing a guarantee of any kind. This plan is for guidance purposes only and should not be used as such by any prospective purchaser. The accuracy, legibility and applicability of these plans and floor plans are guaranteed as to their availability or otherwise can be given.
Floor plan reference: 15/02/21

Main Description:

This is a blank canvass for a FTB or property speculator to stamp their own mark on . Within walking distance of Colne sports centre and the bars and bistros, Colne has to offer . Essential work has been carried out and now is the time to put the finishing touches to a substantial home. The accommodation is arranged over 3 floors and offers 2 reception rooms 2 bedrooms kitchen, bathroom, cellar and externally a spacious yard to the rear. The front looks out over open space and over "south valley " and is convenient for open countryside, railway station and M65 motorway



IMPORTANT: We would like to inform prospective purchasers that these sales particulars have been prepared as a general guide only. A detailed survey has not been carried out, nor the services, appliances and fittings tested. Room sizes should not be relied upon for furnishing purposes and are approximate. If floor plans are included, they are for guidance only and illustration purposes only and may not be to scale. If there are any important matters likely to affect your decision to buy, please contact us before viewing the property