

Because life is

Petty Real™

For Sale



7 Clegg Street
Nelson BB9 0RT

£72,950



Set in an established and popular residential row this bay fronted mid terrace home has been well maintained over the years and benefits from gas fired central heating and UPVC double glazing. Conveniently located being within walking distance of local facilities and amenities and the M65 motorway is within a ten minute drive that connects into the major conurbations of the North West.

Key Features:

- Bay fronted mid terrace home
- Ideal purchase for FTB
- Living room
- 3-Piece bathroom in white
- Recently paved patio in Indian stone
- Popular residential row
- 2 Bedrooms
- Fitted kitchen
- Garden forecourt
- GFCH & UPVC dg

Tenure: Freehold
EPC Rating: D
Council Tax Band: A



2 BEDROOM House - Terraced

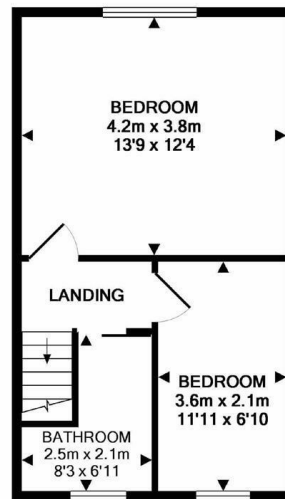
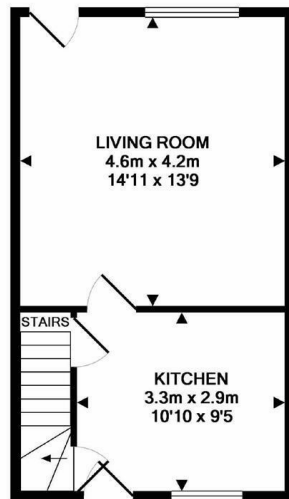

GROUND FLOOR
APPROX. FLOOR
AREA 31.0 SQ.M.
(334 SQ.FT.)

1ST FLOOR
APPROX. FLOOR
AREA 31.0 SQ.M.
(334 SQ.FT.)

TOTAL APPROX. FLOOR AREA 62.1 SQ.M. (668 SQ.FT.)

Whilst every attempt has been made to ensure the accuracy of the floor plan contained here, measurements of doors, windows, rooms and any other items are approximate and no responsibility is taken for any error, omission, or mis-statement. This plan is for illustrative purposes only and should be used as such by any prospective purchaser. The services, systems and appliances shown have not been tested and no guarantee as to their operability or efficiency can be given
Made with Metropix ©2018

Main Description:

Set in an established and popular residential row this bay fronted mid terrace home has been well maintained over the years and benefits from gas fired central heating and UPVC double glazing. Conveniently located being within walking distance of local facilities and amenities and the M65 motorway is within a ten minute drive that connects into the major conurbations of the North West.



IMPORTANT: We would like to inform prospective purchasers that these sales particulars have been prepared as a general guide only. A detailed survey has not been carried out, nor the services, appliances and fittings tested. Room sizes should not be relied upon for furnishing purposes and are approximate. If floor plans are included, they are for guidance only and illustration purposes only and may not be to scale. If there are any important matters likely to affect your decision to buy, please contact us before viewing the property