

Because life is

Petty
Real™

For
Sale



4 Stratton Court
Nelson BB9 0TZ

£109,500



Key Features:

- Two bedroom bungalow
- Fitted Wardrobes
- Semi Detached
- Garage
- Shower Room
- Conservatory
- Garden

Tenure: Freehold
EPC Rating: D
Council Tax Band:



2 BEDROOM Bungalow

GROUND FLOOR
75.3 sq.m. (811 sq.ft.) approx.

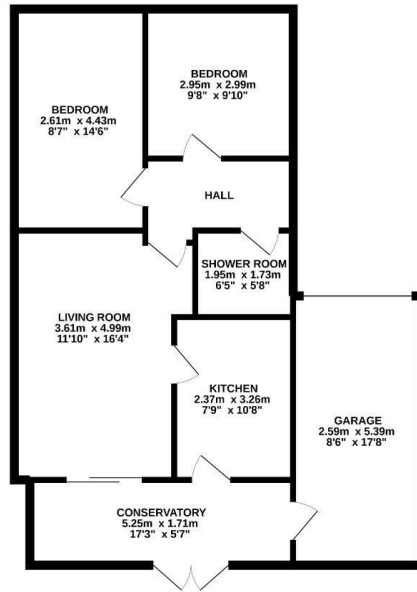

TOTAL FLOOR AREA: 75.3 sq.m. (811 sq.ft.) approx.
Whilst every attempt has been made to ensure the accuracy of the floorplan contained here, measurements of areas, volumes, levels and any other details are approximate and no responsibility is taken for any error, omission or any omissions. This plan is for guidance purposes only and should be used as such by the prospective purchaser. The architect, valuers and real estate agents have not been asked and do not guarantee as to their accuracy or efficiency can be given.
Date: 01/05/2024

Main Description:

Set in a small cul-de-sac location this 2 bedroom semi-detached bungalow is an ideal retirement home. Extended over the years with a conservatory to the rear the property also benefits from an attached single garage and gardens to the front and rear.

The property has fitted bedroom furniture to both bedrooms and a modern fitted kitchen together with a walk-in shower and is within a short drive of all the facilities and amenities that Nelson has to offer.

As you enter the property you have an entrance hall with shower room off to the left and 2 bedrooms to the front, step into the lounge which leads into the conservatory with an adjacent kitchen and internal door to the garage. From the conservatory through double doors to the rear garden

We recommend an internal inspection for the bungalow and location to be fully appreciated



IMPORTANT: We would like to inform prospective purchasers that these sales particulars have been prepared as a general guide only. A detailed survey has not been carried out, nor the services, appliances and fittings tested. Room sizes should not be relied upon for furnishing purposes and are approximate. If floor plans are included, they are for guidance only and illustration purposes only and may not be to scale. If there are any important matters likely to affect your decision to buy, please contact us before viewing the property