

Because life is

# Petty Real™

# For Sale



3 Willow Close  
Barrowford BB9 6PZ

£179,950



Set in a quiet cul-de-sac and conveniently located for both the M65 motorway and the in-vogue village of Barrowford with its bars, bistros and boutiques, this two bedroom detached bungalow offers flexible living accommodation. Benefiting from central heating, double glazing and gardens to front and rear in our opinion this property requires an internal inspection to be fully appreciated.

## Key Features:

- Detached bungalow
- Ideal for retiring couple
- Living room with dining area
- 3-Piece bathroom
- Private rear garden
- Quiet cul-de-sac
- 2 Bedrooms
- Modern kitchen with appliances
- Single garage with utility space
- Conveniently located

Tenure:  
EPC Rating: D  
Council Tax Band: C



134 Gisburn Road, Barrowford, Lancashire, BB9 6HQ  
T: 01282 615900



www.pettyreal.co.uk

# 2 BEDROOM Bungalow - Detached

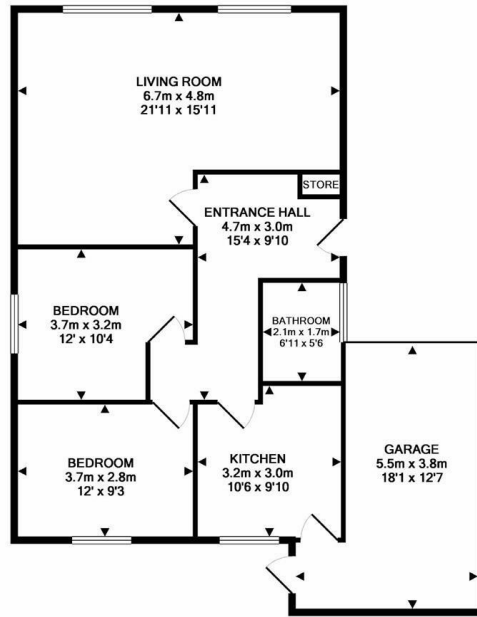

TOTAL APPROX. FLOOR AREA 89.0 SQ.M. (958 SQ.FT.)

Whilst every attempt has been made to ensure the accuracy of the floor plan contained here, measurements of doors, windows, rooms and any other items are approximate and no responsibility is taken for any error, omission, or mis-statement. This plan is for illustrative purposes only and should be used as such by any prospective purchaser. The services, systems and appliances shown have not been tested and no guarantee as to their operability or efficiency can be given.

Made with Metropix ©2019

## Main Description:

Set in a quiet cul-de-sac and conveniently located for both the M65 motorway and the in-vogue village of Barrowford with its bars, bistros and boutiques, this two bedroom detached bungalow offers flexible living accommodation. Benefiting from central heating, double glazing and gardens to front and rear in our opinion this property requires an internal inspection to be fully appreciated.



**IMPORTANT:** We would like to inform prospective purchasers that these sales particulars have been prepared as a general guide only. A detailed survey has not been carried out, nor the services, appliances and fittings tested. Room sizes should not be relied upon for furnishing purposes and are approximate. If floor plans are included, they are for guidance only and illustration purposes only and may not be to scale. If there are any important matters likely to affect your decision to buy, please contact us before viewing the property