

Because life is

PettyTM
Real

13 Ivory Street
Burnley
BB12 6RQ



For Sale

£465 PCM

- Two Bedrooms
- Mid Terrace
- Once Reception Room
- Fitted Kitchen
- Three Piece Bathroom Suite

- Close To Schools
- UPVC Double Glazing
- Gas Fired Central Heating
- Deposit £465
- NO SMOKERS



Situated close to the ever popular Tim Bobbin area, you will find this freshly refurbished property on Ivory St. Briefly comprising two bedrooms, one reception room, fitted kitchen and three piece family bathroom with shower over bath.

Close to all local amenities, schools and major transport links.

The delightful home boasts full UPVC double glazing and Gas Fired Central Heating throughout. Ideal for single occupiers, couples or small families.

NO SMOEKRS

GROUND FLOOR
26.3 sq.m. (283 sq.ft.) approx.

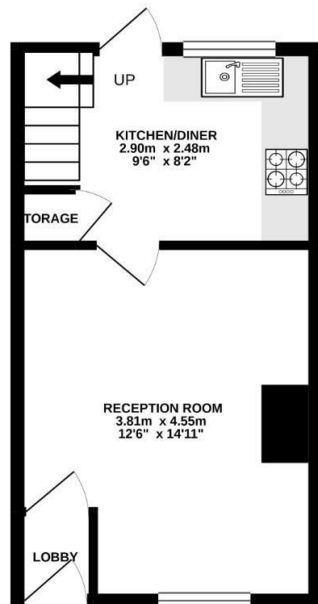

1ST FLOOR
26.4 sq.m. (284 sq.ft.) approx.

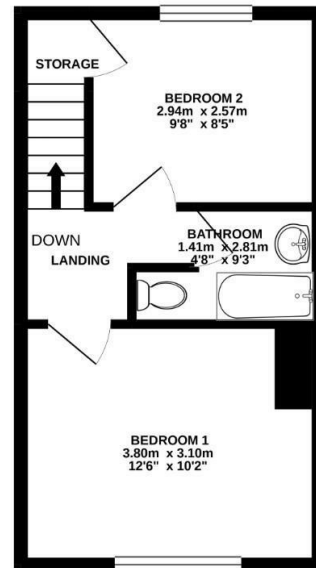

TOTAL FLOOR AREA - 52.7 sq.m. (567 sq.ft.) approx.

Whilst every attempt has been made to ensure the accuracy of the floorplan contained herein, measurements of doors, windows, rooms and any other items are approximate and no responsibility is taken for any error, omission or mis-statement. This plan is for illustrative purposes only and should be used as such by any prospective purchaser. The services, systems and appliances shown have not been tested and no guarantee as to their operability or efficiency can be given.
Made with Metropix ©2021



These particulars, whilst believed to be accurate are set out as a general outline only for guidance and do not constitute any part of an offer or contract. Intending purchasers should not rely on them as statements of representation of fact, but must satisfy themselves by inspection or otherwise as to their accuracy. No person in this firm's employment has the authority to make or give any representation or warranty in respect of the property.

26 Manchester Road, Burnley, Lancashire, BB11 1HH

T.

burnley.sales@pettyreal.co.uk burnley.lettings@pettyreal.co.uk
property.management@pettyreal.co.uk

www.pettyreal.co.uk