

Because life is

PettyTM
Real

23 Laithe Street
Colne
BB8 8AX



For Sale
Reduced To £84,950



GROUND FLOOR
42.7 sq.m. (460 sq.ft.) approx.

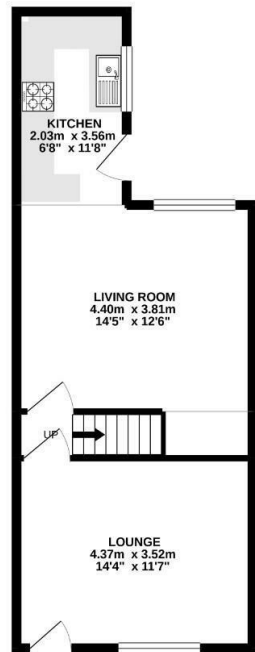

1ST FLOOR
35.9 sq.m. (386 sq.ft.) approx.

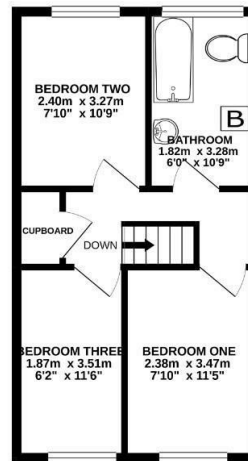

TOTAL FLOOR AREA: 78.6 sq.m. (846 sq.ft.) approx.

Whilst every attempt has been made to ensure the accuracy of the floorplan contained herein, measurements of floors, rooms, windows and any other items are approximate and no responsibility is taken for any error, omission or mis-statement. The plan is for illustrative purposes only and should be used as such by any prospective purchaser. The exactness, dimensions and applications shown here are not intended and no guarantee as to their operability or efficiency can be given.
House ref: M3002



These particulars, whilst believed to be accurate are set out as a general outline only for guidance and do not constitute any part of an offer or contract. Intending purchasers should not rely on them as statements of representation of fact, but must satisfy themselves by inspection or otherwise as to their accuracy. No person in this firm's employment has the authority to make or give any representation or warranty in respect of the property.