

Because life is

Petty
Real™

67 Skipton Road
Colne
BB8 0NU



For Sale

£615 PCM

- Terrace Property
- Three Bedrooms
- Modern Fitted Kitchen
- Large Yard With Decking
- Built in Wardrobes

- Close To M65 Motorway
- Council Tax: A
- EPC: D
- Deposit £615
- NO SMOKERS



Traditional stone-built mid terraced house occupying a convenient and level position within comfortable walking distance of all local amenities including Colne town centre, Park Primary School, Park High School and local supermarkets.

Accommodation is presently arranged over two floors and comprises on the ground floor; a pleasant and well-proportioned lounge; inner hallway where the staircase ascends to the first floor; to the rear of the property is a dining kitchen which houses a range of matching wall, base and drawer units and a gas hob with an electric oven.

To the first floor, the master bedroom is situated to the front of the property and comprises of an excellent double with a range of fitted; the second and third bedrooms are situated to the rear of the property; the bathroom houses a three-piece bathroom suite in white & black with a shower over.

External to the front of the property is a garden forecourt with natural stone boundary walling and wrought iron gates and to the rear is a larger enclosed paved yard with decking.

Property is further complemented by modern day comforts of UPVC double glazing throughout and gas fired central heating and has recently undergone a cosmetic refurbishment with neutral décor throughout, new carpets and vertical blinds in most rooms.

Our initial tenancy agreements are for 12 months.

No smokers

GROUND FLOOR
34.4 sq.m. (370 sq.ft.) approx.

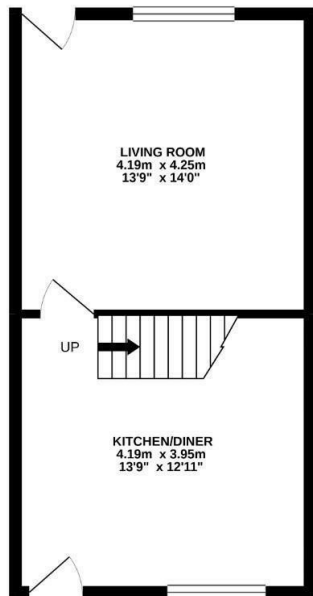

1ST FLOOR
34.4 sq.m. (370 sq.ft.) approx.

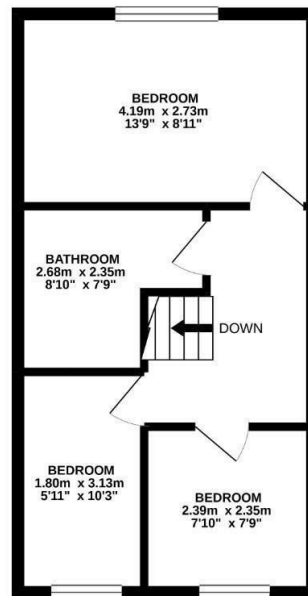

TOTAL FLOOR AREA : 68.7 sq.m. (740 sq.ft.) approx.
Whilst every attempt has been made to ensure the accuracy of the floorplan contained herein, measurements of doors, windows, rooms and any other items are approximate and no responsibility is taken for any error, omission or mis-statement. This plan is for illustrative purposes only and should be used as such by any prospective purchaser. The services, systems and appliances shown have not been tested and no guarantee as to their operability or efficiency can be given.
Made with Makroplan ©2009



These particulars, whilst believed to be accurate are set out as a general outline only for guidance and do not constitute any part of an offer or contract. Intending purchasers should not rely on them as statements of representation of fact, but must satisfy themselves by inspection or otherwise as to their accuracy. No person in this firm's employment has the authority to make or give any representation or warranty in respect of the property.

26 Manchester Road, Burnley, Lancashire, BB11 1HH

T.

burnley.sales@pettyreal.co.uk burnley.lettings@pettyreal.co.uk
property.management@pettyreal.co.uk

www.pettyreal.co.uk