

Because life is

Petty RealTM

27 Meadow Close
Burnley
BB10 2QU



For Sale

- Detached Bungalow
- Three Bedrooms
- Lovely Sized Lounge
- Single Garage
- Utility Room

Offers Over £250,000

- Fitted Kitchen
- Stunning Garden/Large Plot
- Option To Purchase With No Chain
- Multi - Fuel Burner
- Freehold



Experience modern and peaceful living at its finest with this ready-to-move-into, three-bedroom Bungalow offering quiet surroundings and on the doorstep countryside with the local community Reedley Hallows Park. This property offers versatile living accommodation and is within easy reach of Brierfield and Burnley town centre and access to transport links can be reached within just a few minutes walk. The property is arranged on ground level and briefly comprises garage, entrance hallway, utility, kitchen, lounge, conservatory, second hallway, bathroom, W.C., and three bedrooms.

The spacious garage can accommodate a single car and is the perfect space for storage. The Utility room houses the boiler for the property and has plenty of space for appliances. The modern kitchen houses matching wall, base and drawer, contrasting countertops, stainless steel sink, integrated gas hob with extractor fan, and built-in oven with combi microwave.

The three bedrooms can all accommodate double beds. Bedroom two has the benefit of a built-in open storage cupboard. Bedrooms one and two both have sliding doors that access the back garden.

The spacious lounge is the perfect space to entertain family and friends and has a multi-fuel burner set within a brick-feature fireplace. The conservatory is an exceptional part of this property and is utilized as a dining and second living space. Surrounded by wall-to-ceiling double-glazed windows, natural light floods the space.

The bathroom comprises towel radiator, three-piece suit, walk-in shower cubicle, vanity wash basin, and low-level W.C. The W.C. room comprises a floating wash basin and low-level W.C.

To the front of the property, you will find a tarmac driveway. To the rear, you will find a south-facing huge plot, that has the potential to extend. Patio seating area, large lawn areas, a feature pond, summer house, and space for storage sheds.

Don't miss out on the chance to make this Bungalow your new home!

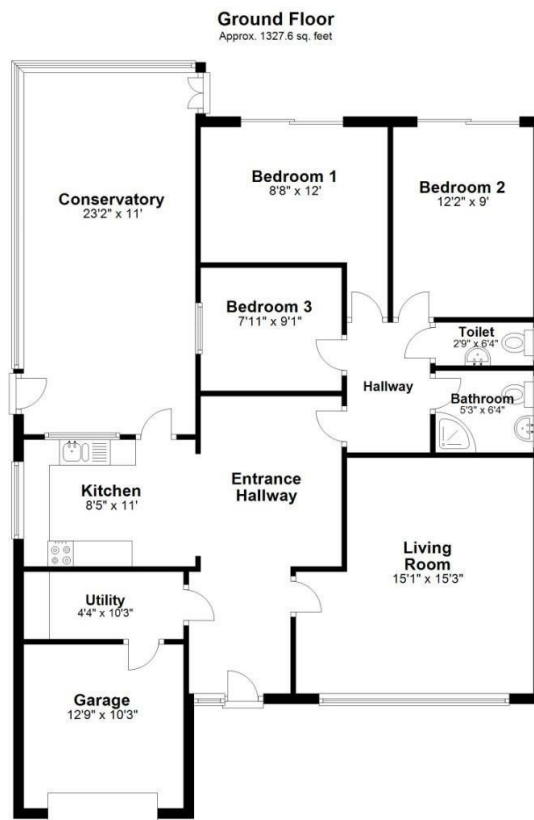

Total area: approx. 1327.6 sq. feet



These particulars, whilst believed to be accurate are set out as a general outline only for guidance and do not constitute any part of an offer or contract. Intending purchasers should not rely on them as statements of representation of fact, but must satisfy themselves by inspection or otherwise as to their accuracy. No person in this firm's employment has the authority to make or give any representation or warranty in respect of the property.

4 Manchester Road, Burnley, Lancashire, BB11 1HH
T.

burnley.sales@pettyreal.co.uk burnley.lettings@pettyreal.co.uk
property.management@pettyreal.co.uk

www.pettyreal.co.uk