

Because life is

PettyTM
Real

6 Linton Gardens
Barrowford
BB9 8RG



For Sale

£265,000

- Detached bungalow
- Popular Wheatley Springs development
- Ideal for the downsizer
- 2 Bedrooms
- Superb South facing garden

- Lounge with French doors
- Dining kitchen
- Modern three piece shower room
- Detached garage
- GFCH & DG



An excellent opportunity to purchase a two bedroom detached bungalow on the popular Wheatley Springs development. Set in a quiet cul-de-sac and within walking distance of all the facilities and amenities that the in-vogue village of Barrowford has to offer, yet open countryside off Wheatley Lane Road is on the doorstep. An ideal purchase for anyone wishing to downsize and providing easily maintained two bedroom accommodation.

The property comprises, entrance hallway accessed via double glazed door, spacious lounge with living flame gas fire set in a marble feature fireplace with marble hearth and timber fire surround, French doors provides access out onto the rear patio and garden. Fully fitted dining kitchen with a range of fitted base and wall units to include integrated appliances, Zanussi oven and four ring gas hob, 1½ bowl stainless steel sink unit with mixer tap over, all having complementary work surfaces and feature tiled splash backs, breakfast bar. Two well proportioned double bedrooms, the main bedroom benefits from mirror fronted fitted wardrobes. Modern three piece shower includes walk in shower, low level wc, wash basin and part tiled splash backs.

To the front of the property is a neatly maintained garden area laid mainly to lawn with mature conifer, tree and shrub borders, block paved driveway leading down the side of the property to a detached single garage. To the rear is a south facing garden with patio adjacent to the house, rockery, lawn area and mature tree and shrub borders, an ideal place to enjoy those sunny afternoons.

No chain

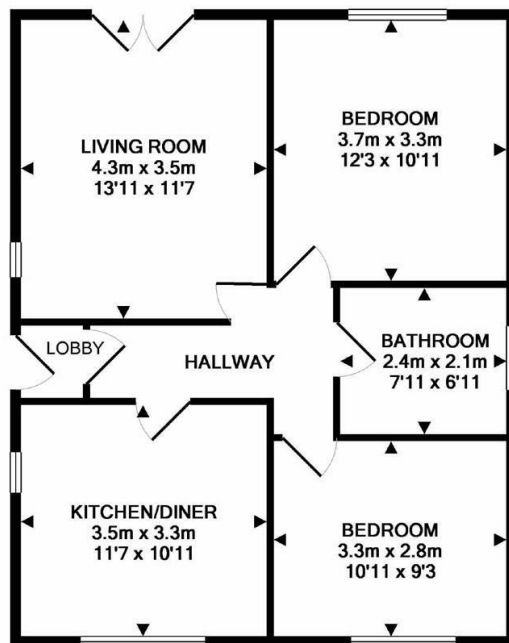

TOTAL APPROX. FLOOR AREA 59.5 SQ.M. (640 SQ.FT.)

Whilst every attempt has been made to ensure the accuracy of the floor plan contained here, measurements of doors, windows, rooms and any other items are approximate and no responsibility is taken for any error, omission, or mis-statement. This plan is for illustrative purposes only and should be used as such by any prospective purchaser. The services, systems and appliances shown have not been tested and no guarantee as to their operability or efficiency can be given
Made with Metropix ©2018



These particulars, whilst believed to be accurate are set out as a general outline only for guidance and do not constitute any part of an offer or contract. Intending purchasers should not rely on them as statements of representation of fact, but must satisfy themselves by inspection or otherwise as to their accuracy. No person in this firm's employment has the authority to make or give any representation or warranty in respect of the property.

134 Gisburn Road, Barrowford, Lancashire, BB9 6HQ
T. 01282 615900
Barrowford.sales@pettyreal.co.uk

www.pettyreal.co.uk