

Because life is

Petty<sup>TM</sup>  
Real

17 Garnett Street  
Barrowford  
BB9 8PA



For Sale

£110,000

- MID TERRACE HOUSE
- POPULAR VILLAGE LOCATION
- IDEAL FOR FIRST TIME BUYER OR INVESTOR
- TWO BEDROOMS
- ONE RECEPTION ROOM

- DINING KITCHEN
- HOUSE BATHROOM
- GFCH & DOUBLE GLAZING
- YARD TO REAR
- EARLY VIEWING ADVISED



## IDEAL FOR FIRST TIME BUYER OR INVESTOR.

Nestled in a prime location, this charming two-bedroom mid-terraced home is perfectly situated within strolling distance of Barrowford's vibrant array of bars, bistros, and boutiques. Boasting the advantages of central heating and double glazing. This residence is an ideal opportunity for the First Time Buyer or Investor.

Upon entering the property through the entrance vestibule, you'll find a welcoming living room that seamlessly transitions to a well-appointed dining kitchen. Ascend to the first floor, where two generously sized double bedrooms and a tastefully designed house bathroom await.

To complete the picture, a rear yard offers a private outdoor space for your enjoyment.

No chain.

GROUND FLOOR  
35.6 sq.m. (383 sq.ft.) approx.

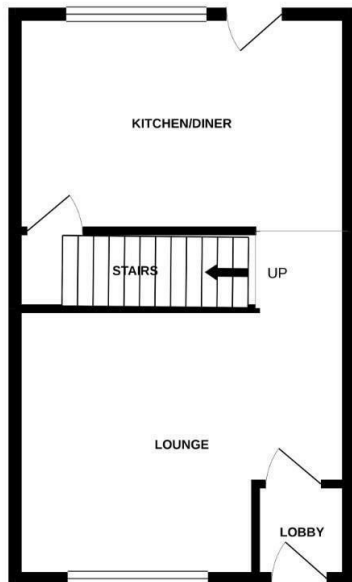

1ST FLOOR  
35.6 sq.m. (383 sq.ft.) approx.

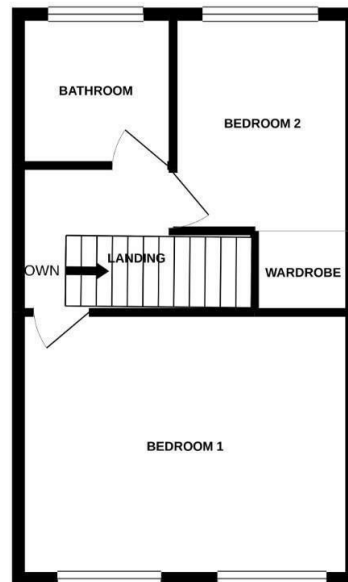

TOTAL FLOOR AREA: 71.2 sq.m. (767 sq.ft.) approx.

Whilst every attempt has been made to ensure the accuracy of the floorplan contained herein, measurements of doors, windows, rooms and any other items are approximate and no responsibility is taken for any error, omission or mis-statement. This plan is for illustrative purposes only and should be used as such by any prospective purchaser. The services, systems and appliances shown have not been tested and no guarantee as to their operability or efficiency can be given.  
Made with Metropix ©2020



These particulars, whilst believed to be accurate are set out as a general outline only for guidance and do not constitute any part of an offer or contract. Intending purchasers should not rely on them as statements of representation of fact, but must satisfy themselves by inspection or otherwise as to their accuracy. No person in this firm's employment has the authority to make or give any representation or warranty in respect of the property.

134 Gisburn Road, Barrowford, Lancashire, BB9 6HQ  
T. 01282 615900  
Barrowford.sales@pettyreal.co.uk

[www.pettyreal.co.uk](http://www.pettyreal.co.uk)