



## Flat , Barge Court, Tattershall Road, Boston Guide Price £78,000

\*\*\*GUIDE PRICE £78,000 - £82,500\*\*\*

\*\*\*CURRENTLY RENTED OUT ACHIEVING AN APPROX RENTAL YIELD OF OVER 9%\*\*\*

NO ONWARD CHAIN & IDEAL INVESTMENT OR FIRST TIME BUY PURCHASE!

RECENTLY REFURBISHED 1 bedroom flat located within the centre of town!

**01205356380**

boston@plotway.co.uk

**P**lotway

\*\*\*GUIDE PRICE £78,000 - £82,500\*\*\*

\*\*\*CURRENTLY RENTED OUT ACHIEVING AN APPROX RENTAL YIELD OF OVER 9%\*\*\*

NO ONWARD CHAIN & IDEAL INVESTMENT OR FIRST TIME BUY PURCHASE!

Internal accommodation briefly comprises of entrance hall, living room, bedroom, kitchen and shower room!

The property itself has recently been refurbished to a high standard which includes modern kitchen, new consumer units, modernised shower room - COMPLETE WITH NEW DOUBLE SHOWER! as well as being decorated throughout & new floorings!

The property also has one parking space.

being conveniently located the town centre itself is only a short walk away a long with various cafes, restaurants, shops, doctors surgery and train station!

For lease and maintenance costs please contact the selling agent

#### **Entrance hall**

#### **Living Room**

w: 3.8m x l: 4.5m (w: 12' 6" x l: 14' 9")

#### **Kitchen**

w: 3.3m x l: 3.8m (w: 10' 10" x l: 12' 6")

#### **Bedroom**

w: 3.9m x l: 3.6m (w: 12' 10" x l: 11' 10")

#### **Shower Room**

w: 1.4m x l: 2.5m (w: 4' 7" x l: 8' 2")



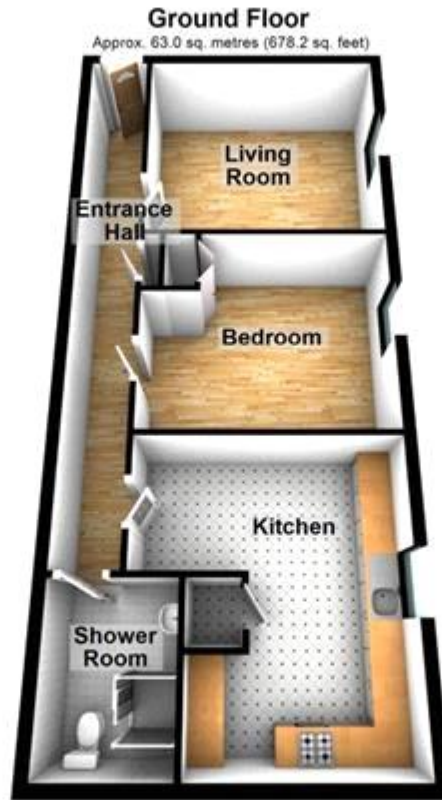

Total area: approx. 63.0 sq. metres (678.2 sq. feet)



| Energy Efficiency Rating                    |                         |           |
|---|-------------------------|-----------|
|   | Current                 | Potential |
| Very energy efficient - lower running costs |                         |           |
| (92-100) <b>A</b>                           |                         |           |
| (81-91) <b>B</b>                            |                         | 82        |
| (69-80) <b>C</b>                            |                         |           |
| (55-68) <b>D</b>                            | 55                      |           |
| (39-54) <b>E</b>                            |                         |           |
| (21-38) <b>F</b>                            |                         |           |
| (1-20) <b>G</b>                             |                         |           |
| Not energy efficient - higher running costs |                         |           |
| <b>England &amp; Wales</b>                  | EU Directive 2002/91/EC |           |

The energy efficiency rating is a measure of the overall efficiency of a home. The higher the rating the more energy efficient the home is and the lower the fuel bills will be.

Whilst every effort is made to ensure the accuracy of these details, it should be noted that the measurements are approximate only. Floorplans are for representation purposes only and prepared according to the RICS Code of Measuring Practice by our floorplan provider. Therefore, the layout of doors, windows and rooms are approximate and should be regarded as such by any prospective purchaser. Any internal photographs are intended as a guide only and it should not be assumed that any of the furniture/fitings are included in any sale. Where shown, details of lease, ground rent and service charge are provided by the vendor and their accuracy cannot be guaranteed, as the information may not have been verified and further checks should be made either through your solicitor/conveyance. Where appliances, including central heating, are mentioned, it cannot be assumed that they are in working order, as they have not been tested. Please also note that wiring, plumbing and drains have not been checked.